

## 24 The Opal era

The Pearl Consortium was selected as the successor to the failed T Card. The name Opal Card was chosen from 350 others as the state gem of NSW. Trials on the Neutral Bay ferry run started on 7 December 2012 with 200 selected customers. Opal Cards could be ordered by the public from this date. Fare for a 1 journey was set at \$5.60 (same as My Ferry Inner Harbour Zone 1) and there were some complaints that FerryTens cost \$4.60. It was soon announced that weekly fare would be capped at \$44.80- the price of a FerryTen. Daily travel is capped at \$15 (against MyZone daily pass of \$20) and Sunday unlimited travel is \$2.50. Registered Opal Cards can have 18 months of travel information downloaded via the Opal website. Only adult cards were initially available though senior/pensioner and student cards are promised. There will also be cards for one off use. Trials on trains and buses to begin later. Cards can be topped up and sold from local vendors. Cards have to be tapped on and off for each journey. After 8 weekly paid journeys the remainder are free. By 2015 42 ferry wharves, 307 train stations on the Cityrail network and more than 5000 buses and light rail will be using the system.

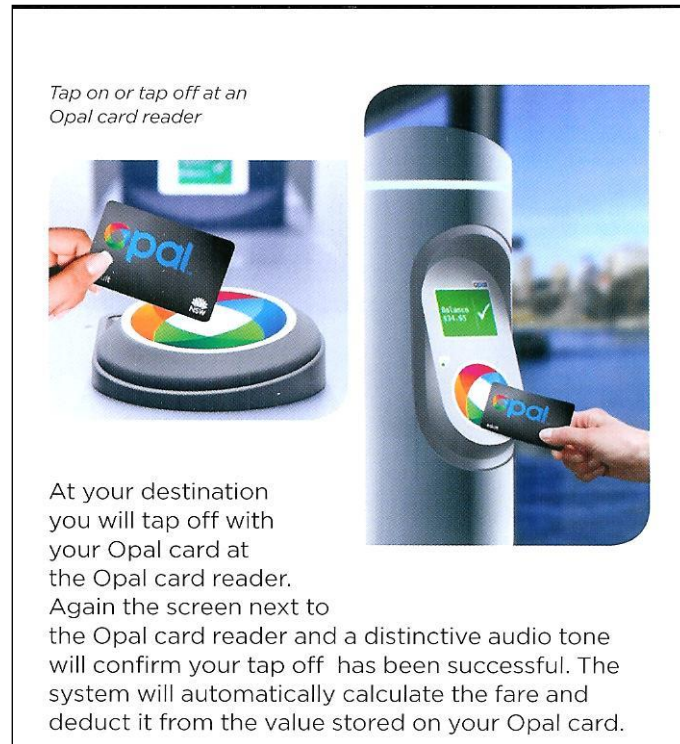



Trial extended to Manly Ferry 8 April 2013. Tag on once (Circular Quay), no terminals at Manly as this service does not interact with any other. Trial extended to eastern Suburbs trains 16.6.13, and Mosman, Zoo & Eastern Suburbs ferries 12.8.13





2013 concession card added (top). Not introduced till 2015. Pensioner Oct 2014. Child earlier 2014.

Trial on 594H and 333 buses, extended to all Hornsby depot services. Opal card used as a flash pass on E32 E35 E36 E41 (Manly) as a promo till 29.6.14.

The original press release of 2012 also had a bluish student card.



School free passes ended 2015. From 2016 replaced by Opal school card.





Topping up at an Opal agent.

Opal top up/daily ticket machines from 2015.



From 1.1.16 the Senior Opal Card was available on the Cronulla & National Park Ferry, the Church Point Ferry, the Brooklyn Ferry and the Palm Beach Ferry. It is used as a flash pass.



Various details as required on back (eg access or not to airport train).

Opal daily card machine available from train stations from 23 March 2016. Credit and cash & credit card types. Credit machines at Artarmon, Blacktown, Granville, Hornsby, Kingswood, Pymble, Roseville, Wahroonga, Waverton, Wentworthville Stations. Cash & credit card machines at Bondi Junction, Edgecliff, Emu Plains, Green Square, Martin Place, Milsons Point, Mt Druitt, North Sydney, Penrith, Quakers Hill, St Marys, Warawee, Werrington and Wollstonecraft Stations. Fares are slightly above Opal card equivalents: Adult fare band 1 \$4, 2 \$4.80, 3 \$5.40, 4 \$7, 5 \$8.80. Child/youth and half these prices. No concessions. Later locations include Manly and Circular Quay wharves.



Bus paper tickets (green machines) and single rail tickets to be withdrawn October 2016. **Newcastle** time based withdrawn, driver issued My Zone.

From 5.9.16 transfer discount (adult \$2/conc\$1) between modes introduced. Opal fares frozen also. No change to 60 minute transfer on same mode. Weekly rewards also changed from free to half price after 8 paid journeys.

Trial of credit/debit cards proposed for 2017 in lieu Opal card. Opal Single ticket train type card still has Toronto valid which includes train & bus travel. No bus/train reverse journey type though.



Free travel for the blind. (noticed 9/16)



From 1 August 2016 the generic Opal type subtitled Newcastle Buses was used. Changed to “Newcastle Transport” from 1.7.17.